

08/10/11 81G05A
EXTERIOR REAR VIEW MIRROR
ELECTRIC FOLDING EXT MIRROR + DIODE

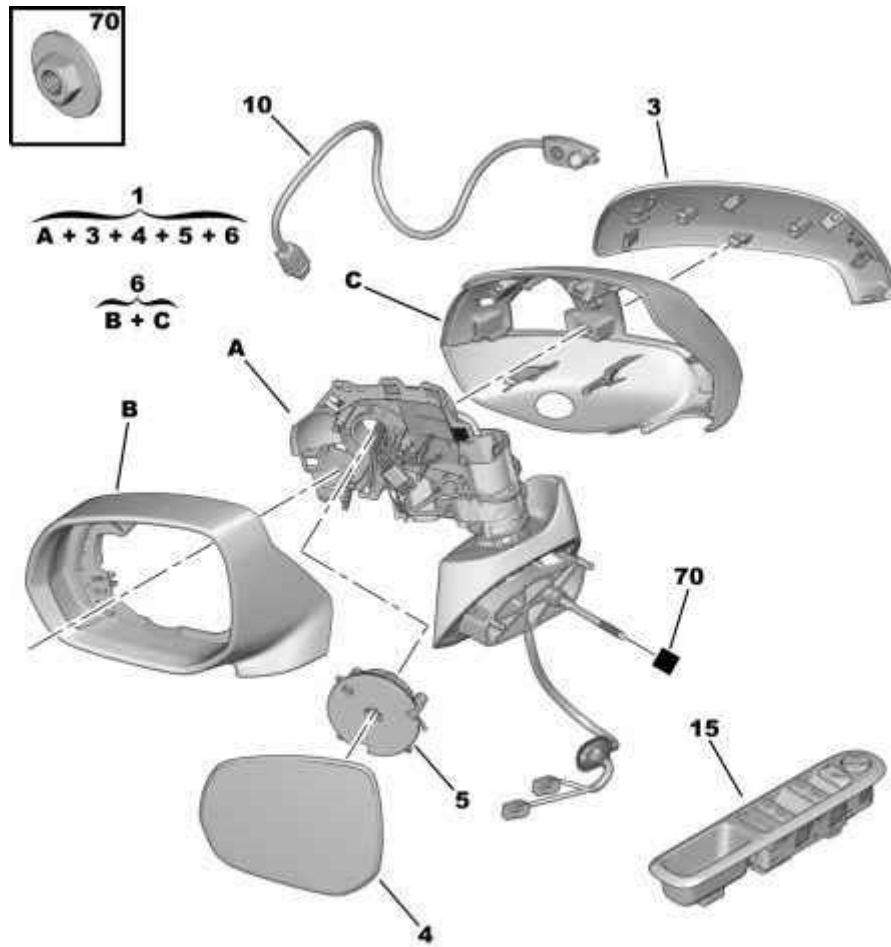

06/2009 8T 81G05A

01	8153 ZV 8153 ZG	01 01	DRIVER OUTSIDE EXT VIEW MIRROR LEFT RIGHT
03	8152 H0 8152 H1	01 01 01 01	MIRROR COVERS ALLIAGE LEFT <i>- BODY COLOUR EXT MIRROR+COLOUR-DYED MIRROR BASE</i> LEFT <i>- BODY COLOUR EXT MIRROR+BODY COLOUR MIRROR BASE</i> RIGHT <i>- BODY COLOUR EXT MIRROR+COLOUR-DYED MIRROR BASE</i> RIGHT <i>- BODY COLOUR EXT MIRROR+BODY COLOUR MIRROR BASE</i>
04	8151 PF 8151 PG 8151 PH 8151 PJ	01 01 01 01	REAR VIEW MIRROR LEFT <i>- EXCEPT CONVEX EXTERIOR MIRROR GLASS + ARABIE MARKING</i> RIGHT <i>- EXCEPT CONVEX EXTERIOR MIRROR GLASS + ARABIE MARKING</i> LEFT <i>- CONVEX EXTERIOR MIRROR GLASS + ARABIE MARKING</i> RIGHT <i>- CONVEX EXTERIOR MIRROR GLASS + ARABIE MARKING</i>
05	6602 48 6602 J2	01 01	VIEW MIRROR MOTOR <i>LEFT</i> <i>RIGHT</i>
06	8152 H6 8152 H7	01 01	MIRROR SHELL KIT LEFT RIGHT
10	6445 F9	01	AIR TEMPERATURE PROBE
15	6490 X6	01	CONTACTOR PLATE HZD- - NERO MISTRAL
70	4503 43	01	NUT WITH BASE M8X125-8-13