

22/10/11 348001 FIXING POWER UNIT

UNTIL RPO 09673

A) FROM O 08842 + 6922 17 (1)

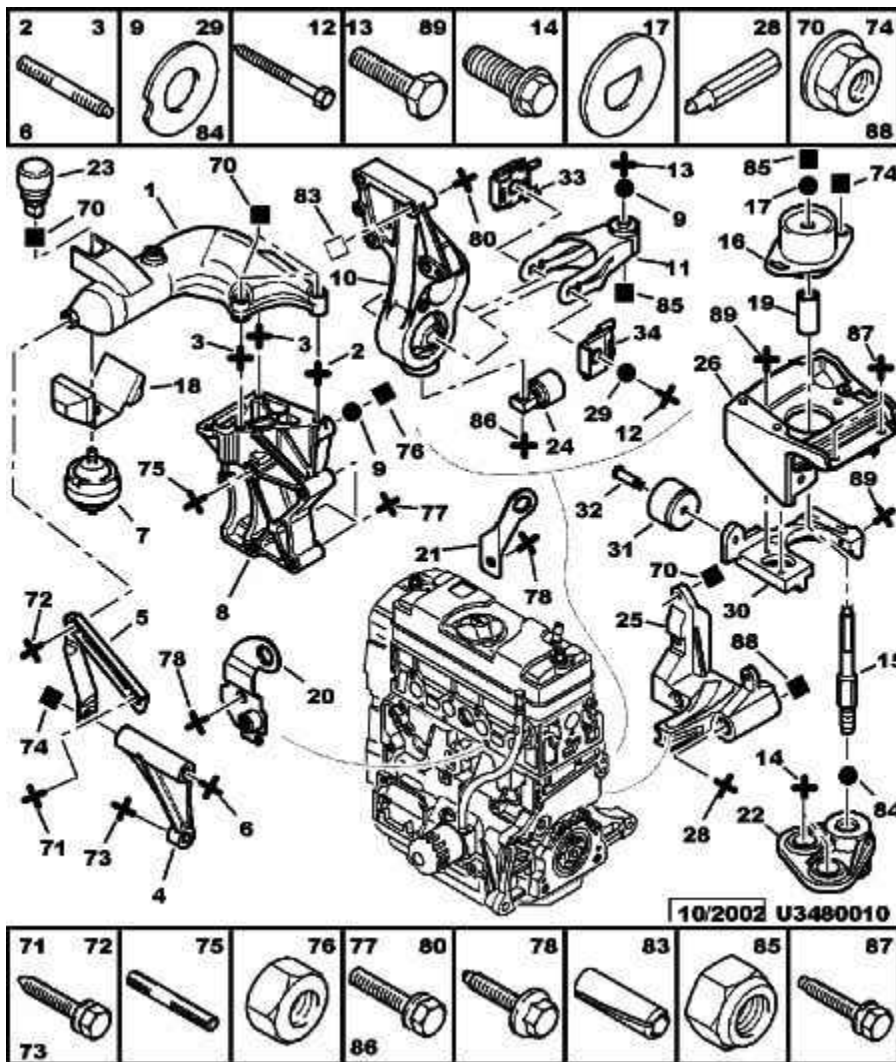

01	1839 70	01	ENGINE MOUNTING BRACKET RIGHT
02	1803 35	01	STUD 10X150-58-20
03	1803 69	01	STUD 10X150-66-21
04	1805 11	01	ENGINE SUSPENSION BRACKET RIGHT SUP
05	1805 13	01	ENGINE SUSPENSION STRUT RIGHT SUP
06	1803 70	01	STUD 8X125-100-16
07	1844 75	01	ENGINE ELASTIC MOUNTING BRACKET RIGHT SUP
08	1839 26	01	ENGINE MOUNTING BRACKET RIGHT INF
09	4010 H4	02	PLAIN WASHER
10	1807 H8	01	ENGINE MOUNTING BRACKET ASS (INT INF)
11	1806 42	01	ANTI-TORQUE LINK ASS
12	6922 17 1803 33	01 01 01 01 01	HEX HEAD CAPSCREW DIAM 10X150-90 - UNTIL RPO 08842 DIAM 10X150-90 - SINCE RPO 08843 UNTIL RPO 09456 DIAM 10X150-72 - SINCE RPO 09457
13	1803 42	01	HEX HEAD CAPSCREW DIAM 12X175-58
14	1803 30	02	SCREW WITH WASHER DIAM 14X150-40
15	1803 67	01	PIN BUFFER LEFT 12X175-25 14X150-29 - AGE >= 2
16	1844 68	01	ENGINE ELASTIC MOUNTING BRACKET LEFT
17	1841 05	01	ENGINE SUSPENSION FIX WASHER DIAM 12X24
18	1844 A7	01	BUFFER
19	1814 29	01	SPACER
20	1880 63	01	ENGINE HOISTING HOOK ECH
21	1880 53	01	ENGINE HOISTING HOOK ADM
22	1807 H5	01	ENGINE MOUNTING BRACKET INTM INF
23	1844 80	01	ENGINE VIBRATIONS SHOCK-ABSORB SUP
24	1844 81	01	ENGINE VIBRATIONS SHOCK-ABSORB INF
25	1890 22	01	ENGINE-G/BOX ASSY IMPACTOR DIAM 8(2)-DIAM 10(2)
26	1813 58	01	ENGINE MOUNTING BRACKET ASS INT
28	1803 86	02	COLUMN SCREW RDL DIAM 7X100
29	1812 34	01	PLAIN WASHER 10X18-2
30	1846 89	01	VIBRATE WEIGHT
31	1844 88	01	ENGINE VIBRATIONS SHOCK-ABSORB

	1844 90	01	
32	1803 90	01	SHAFT SCREW DIAM 8X125-11
33	1812 53	01	VIBRATE WEIGHT 10X150 <i>SEE A</i>
34	1812 54	01	VIBRATE WEIGHT <i>SEE A</i>
70	6935 C9	07	NUT WITH WASHER
71	<i>6922 76</i> RP 6922 F0	01 01	SELF LOCKING SELF-TAP SCREWS DIAM 8X125-30
72	6923 H3	01	SELF LOCKING SELF-TAP SCREWS M10X150-35
73	6922 88	01	SELF LOCKING SELF-TAP SCREWS DIAM 8X125-40
74	6936 80	06	NUT WITH WASHER DIAM 8X125-9,7-13
75	6930 60	01	STUD 12X175-76-21-21
76	6933 16	01	HEXAGONAL NUT 12X175-12
77	6923 97	03	SELF LOCKING SELF-TAP SCREWS 10X150-L80 CL10,9-ZN
78	6925 71	02	SCREW WITH BASE DIAM 8X125-20
80	<i>6925 R9</i> RP 6922 G8	04 01	SELF LOCKING SELF-TAP SCREWS DIAM 10X150-55
83	6968 51	02	PIN DIAM E8 L12
84	6947 C3	01	PLAIN WASHER 14-60-3
85	6939 77	02	SELF LOCKING NUT 12X175-15-18
86	6923 G7	01	SELF LOCKING SELF-TAP SCREWS DIAM 8X125-35
87	6923 78	04	SELF LOCKING SELF-TAP SCREWS DIAM 8X125-25
88	6936 64	02	NUT WITH BASE 7X100-7-11
89	<i>6921 A5</i> RP 6924 93	03 01	HEX HEAD CAPSCREW DIAM 8X125-16