

22/10/11 532030

ALTERNATOR AND FIXINGS

PETROL AND 2,963L AND 2,975L AND INJECTION

NOTA: L'ALTERNATOR CLASS 7 EST
REPLACED BY ALTERNATOR CLASS 8
DEO TENSION SLIDE 96064313

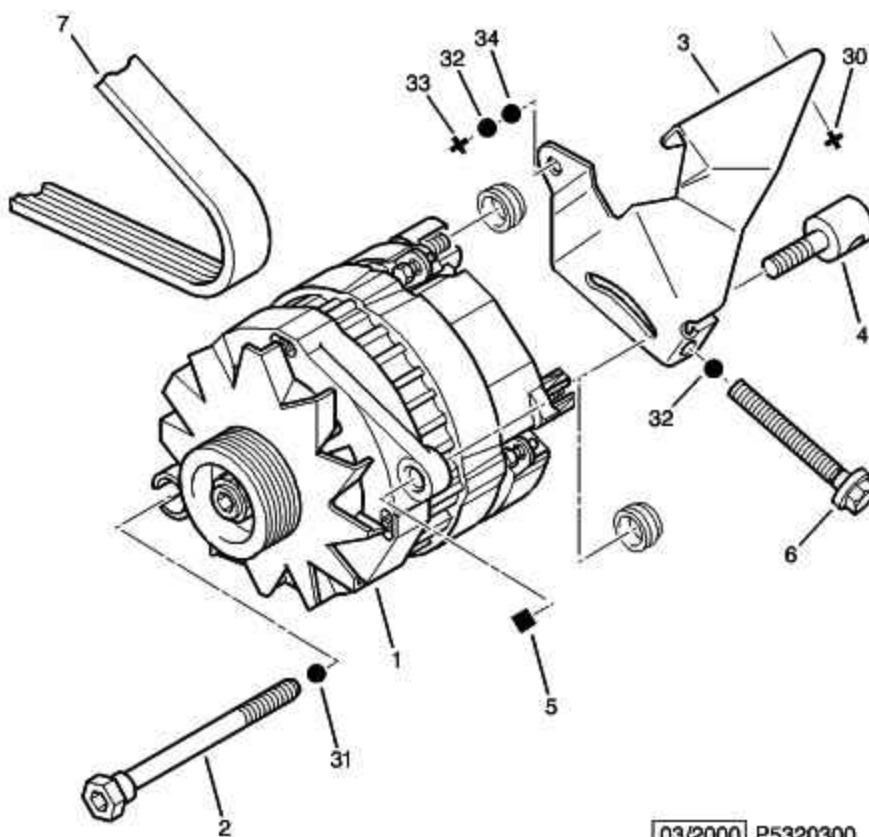
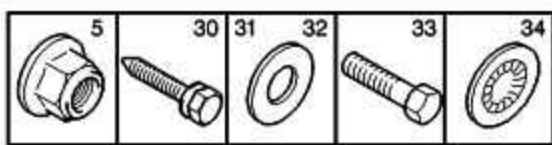

03/2000 P5320300

01	5705 G5	NFP	01	ALTERNATOR NEW CLASSE 9 - 90 AMP MITSUBISHI* - A 004 T 03292 <i>SEE A</i>
			01	CLASSE 9 - 90 AMP MITSUBISHI - A 004 T 02892 <i>SEE A</i>
			01	CLASSE 9 - 90 AMP MITSUBISHI* - A 003 TA 0592 <i>SEE A</i>
			01	CLASSE 9 - 90 AMP VALEO(ALTERNAT) - A 14 N 172 <i>SEE A</i>
			01	CLASSE 9 - 90 AMP VALEO(ALTERNAT) - A 14 N 139 <i>SEE A</i>
			01	CLASSE 9 - 90 AMP VALEO(ALTERNAT) - A 13 VI 108 <i>SEE A</i>
			01	CLASSE 9 - 90 AMP MITSUBISHI - A 002 T 37692 <i>SEE A</i>
			01	CLASSE 9 - 90 AMP MITSUBISHI - A 004 T 00891 <i>SEE A</i>
			01	CLASSE 9 - 90 AMP VALEO(ALTERNAT) - A 13 VI 68 <i>SEE A</i>
			01	CLASSE 9 - 90 AMP MITSUBISHI - A 002 T 13391B/C <i>SEE A</i>
	5705 G6	NFP	01	CLASSE 12 - 120 AMP MITSUBISHI* - A 004 TA 0092 <i>SEE B</i>
			01	CLASSE 12 - 120 AMP MITSUBISHI - A 004 T 00991 <i>SEE B</i>
			01	CLASSE 12 - 120 AMP MITSUBISHI - A 004 T 03492 <i>SEE B</i>
			01	CLASSE 12 - 120 AMP MITSUBISHI* - A 004 T 03392 <i>SEE B</i>
02	5703 47		01	SPINDLE 10X150-125
03	5708 61	NFP	01	ALTERNATOR TENSION SLIDE CL 8-9-12
04	5703 29		01	ALTERNATOR FIXING SCREW
05	6939 83	RP 6939 C2	01	SELF LOCKING NUT DIAM 8X125-7-13
06	5703 30	NFP	01	SCREW WITH BASE DIAM 8X125-80
07	5750 TQ	NFP	01	DRIVE BELT ALTERNATEUR LONG 850-K5
	E117658		01	EM:STREAKED BELT PSA K5 853 <i>- HEATER</i>
	16 063 457 80		01	EM:V BELT PSA
30	6923 G6		02	SELF LOCKING SELF-TAP SCREWS 8X125-20
31	6946 19		01	PLAIN WASHER 14X29-2
32	6947 78		01	PLAIN WASHER 8X16-1,5
33	6923 23	RP 6922 14	01	HEX HEAD CAPSCREW 8X125-40
			01	
34	6962 66		01	TOOTH SPRING WASHER 8X18-1,4

